

E.P.
25

442
4/90

Admissible under Rule 2
of the Land Revenue Act
of 1948 (L.A. No. 390)

S. Blattalaya
Addl. District Magistrate

15/11/83
4/90

THIS INDENTURE made this 12th day of April one thousand nine hundred and eighty ~~on~~ BETWEEN the GOVERNOR OF THE STATE OF WEST BENGAL hereinafter referred to as the "DONOR" (which expression shall unless excluded by or repugnant to the context be deemed to include his successors in office) of ONE PART; AND SHRI/SMT./KM. MADHURI LATA ROY

Son/Wife/Daughter of Late Birendra Lal Roy residing at E.P. 25, Baghajatin E-Block (East), P.S. Jadavpur, 24-Pgs(s)

SHRI/SMT./KM. Son/Wife/Daughter of residing at SHRI/SMT./KM. Son/Wife/Daughter of residing at SHRI/SMT./KM. Son/Wife/Daughter of residing at SHRI/SMT./KM. Son/Wife/Daughter of residing at SHRI/SMT./KM. Son/Wife/Daughter of residing at SHRI/SMT./KM. Hindu residing at

hereinafter called the "DONEE" (which expression shall unless excluded by or repugnant to the context be deemed to include his/her heirs, executors, administrators, representatives and assigns) of OTHER PART.

WHEREAS after the partition of India a large number of residents of former East Pakistan crossed over and came to the territory of the State of West Bengal from time to time due to force of circumstances beyond their control.

AND whereas the Government of West Bengal (hereinafter referred to as the "Government") offered all reasonable facilities to such persons (hereinafter referred to as "Refugees") for residence in West Bengal.

AND whereas a considerable number of such people were compelled by circumstances to use vacant lands in the urban areas for homestead purposes.

AND whereas the DONEE was one of such persons who had come to use and occupy a piece of land particularly described in the schedule hereunder.

AND whereas the DONEE being a refugee displaced from East Pakistan (now Bangladesh) approached the Government of West Bengal for a plot of land for his rehabilitation.

AND whereas the Government of West Bengal with the intent to rehabilitate the refugees from East Pakistan now Bangladesh acquired land in R.S. Dag No. 153(P), 729(P) Mouza Bademamur in Police Station Jadavpur in the District 24-Pgs(s) in the Urban area C.M.C. under the provisions of L.D.P. Act, 1948/L.A. Act I of 1894 including the plot now in occupation of the DONEE.

(Urban-acquired-gift)

AND whereas it has been decided by the Government to make a gift of the said plot of land in favour of the DONEE so as to confer absolute right title and interest in the said land where he has been residing peacefully for a long time more fully described in the schedule hereunder written.

NOW THIS DEED WITNESSETH that in consideration of the premises hereinbefore mentioned and to provide relief to the DONEE in consideration of his/her destitute condition the DONOR doth hereby absolutely give grant and transfer unto the DONEE ALL THAT PIECE AND PARCEL OF LAND more fully described in the schedule hereunder written as homestead land OR HOWSOEVER otherwise the said land hereditaments and premises are or is at any time or times heretofore were situated butted bounded as hereinafter described TOGETHER WITH all ways, paths, passages, easements, privileges, appendages and appurtenances whatsoever with all easements thereto and therein TO HAVE AND TO HOLD THE SAID land hereditaments and premises hereby given granted and transferred unto and to the use of the DONEE forever AND the DONEE shall and may at all times hereafter peaceably and quietly possess and enjoy the said land hereby given granted and transferred subject to the condition that the DONEE shall have no right save as hereinafter provided to alienate or transfer in any way the land comprised in the schedule hereunder written in any manner whatsoever within a period of 10 (ten) years from the date of these presents without obtaining prior written permission of the DONOR which shall not be obligatory on the part of the DONOR to give and which will be granted only in exceptional circumstances of hardship PROVIDED THAT THE DONEE shall be at liberty to mortgage charge or encumber the said land with the Life Insurance Corporation of India or any Nationalised or Scheduled Bank, Co-operative Bank or Government or any Statutory Body or Government Sponsored Financial Institution within this period of ten years for the purpose of construction of a residential building therein and for the purpose of better economic and physical improvement. AND THE DONOR and all persons lawfully and equitably claiming as aforesaid shall and will from time to time and at all times hereinafter at the request and costs of the DONEE do or execute or cause to be done and executed all such acts deeds and things whatsoever for further better and more perfectly assuring the said message land hereditaments and premises and every part thereof unto the DONEE in the manner aforesaid as shall or may be reasonably required.

SCHEDULE
(Four)

ALL THAT PIECE OR PARCEL OF LAND measuring 04 Kh. 08 Ch. 12 Sft. more or less of homestead land in E/P No. 25 in R.S. Plot No. 153(P), 729(P) in Khatian No. N of Mouza Bademaur J. L. No. 31 P. S. T. S. P. M. Y. in the district of 24-P. S. (S.) Sub Registration Office Alipore butted and bounded in the manner following.

On the North. EX Land..

On the East. E.P. - 24 E. Colony Road

On the South. E.P. - 26....

On the West. EX Land

SITE PLAN OF E. PLOT NO. 25, OF BAGHAJATIN
E-BLOCK EAST POST 50 50 COLONY, MOUZA-
BADEMASAR, J.L. NO. 31, P.S.- JADAVPUR. DIST-
24-PARGANAS (S).

SCALE:- 1" = 20'-0"

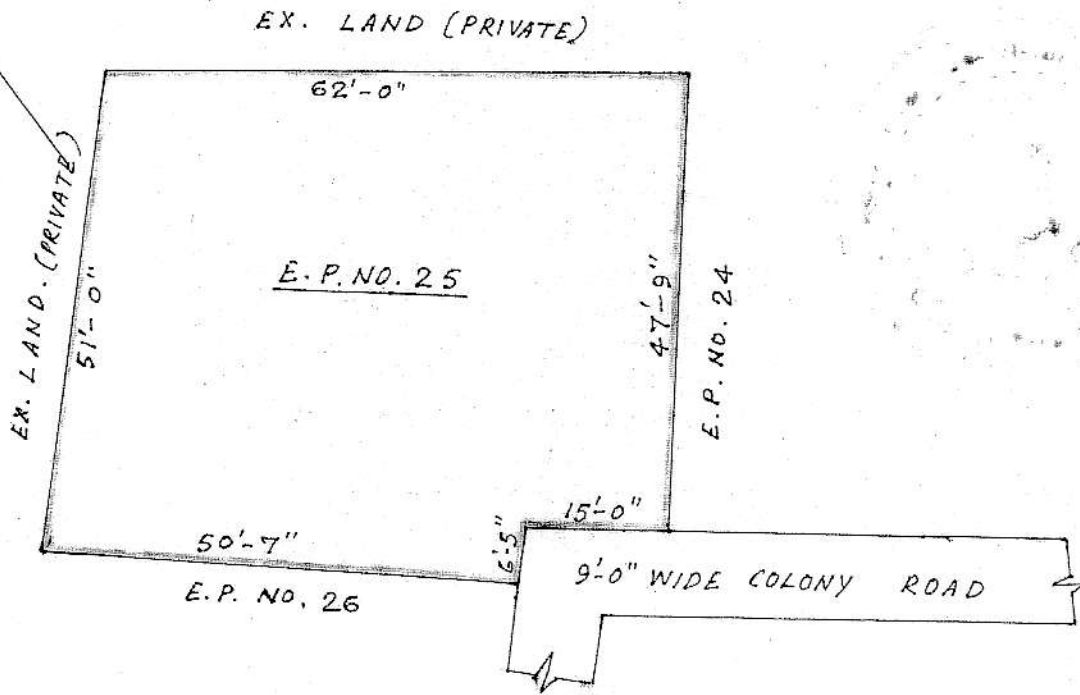

SCHEDULE OF PLOT.

E.P. NO	CORRESPONDING R. S. DAG NO.	NAME OF THE PLOT HOLDER.	MEASURE- MENT.	A R E A			SHOWN IN
				K.	CH.	SFT.	
25	153(P) 789(P)	SMT. MADHURILATA ROY	N-62'-0" S-50'-7" + 15'-0" E-47'-9" + 6'-5" W-51'-0"	4	8	18	

Checked & Found correct
(Surveyor)
Attorney

at the daroga
8/1/92
J. R. O.

DRAWN BY:
 S. Haldar
 SURVEYOR.
 25-7-90

IN WITNESS WHEREOF THE DONOR and THE DONEE have hereunto set and subscribed their respective hands the day, month and year first above written.

Signed and delivered for and on behalf of the Governor

Refugee, Relief and Rehabilitation Department
Government of West Bengal

By the Collector
District

[Signature]
Addl. Sub-Divisional Officer,
South 24 Pgs. Sadar, Alipore.
R. R. & R. Deptt.

[Handwritten signature]

In the presence of:

1st witness

[Signature]
Addl. Rehabilitation Officer,
South 24 Pgs. Alipore.
R. R. & R. Deptt.

Address

Occupation

2nd witness

[Signature]
Surveyor, R. R. & R. Deptt.
South 24 Pgs. Alipore.

Address

Occupation

Signed by the DONEE

1st witness *M. Anindulal Karmakar* Occupation *Service*

Address *4 Bagha Jatin E Block East Cal-86*

2nd witness *Bejoy Ranjan Biswas* Occupation *Business*

Address *Baghajatin-7 E Block-East P.O. Baghajatin Cal-86*

Stamp: *18th* day of *April* 1970
at the Addl. District Registrar,
Alipore, Parganas,
by *Smt. Madhavi Lata Roy*
Power of Attorney constituted by the 3rd
Legal Aid Officer of Alipore, 24.1.71, (2)

TESTIMONY BY *T. Bhattacharyya*
Addl. S.D.O. (Sadar)
I have read from personal
knowledge of his wife under
No. 1 of 1971 of 19
(in the presence of him) perforce
of his seal and signature.

[Signature]
Addl. District Registrar,
South 24 Parganas, Alipore

[Signature]
Addl. District Registrar,
South 24 Parganas



L.T.S - 532

EXECUTION IS ADMITTED
By Sm. Madhure Lal Roy

Son of Late Birendralal Roy
wife of Baghjalini E. Block East
Thana Jadav Pur
District South 24 Parg.
By Caste Hindoo
By Profession Manuscript

Bhattacharyya
Addl. District Register,
South 24-Parganas, Alipora.

Identified by
from the D.O.
S/o Late Anil K. D.O.
P.O. Baghjalini E. Block East
P.S. - Jadavpur,
Dist - 24 Parg (South)
Service

IDENTIFIED BY
Sm. Anam K. D.O.

Son of Late Anil K. D.O.
wife of Baghjalini E. Block East
Thana Jadav Pur
District South 24 Parg.
By Caste Hindoo
By Profession Service

Bhattacharyya
Addl. District Register,
South 24-Parganas, Alipora.

REGISTERED IN
Book No. 1
Volume No. 4
Pages 265 to 268
Serial No. 442
Date 1946

TRUE COPY

Bhattacharyya
Addl. District Register,
South 24-Parganas, Alipora.



Bhattacharyya
Addl. District Register,
South 24-Parganas, Alipora.